

- LEGEND**
- COUNTY BOUNDARY
 - U.S. LAND TOWNSHIP LINE
 - SECTION LINE
 - NATIONAL FOREST BOUNDARY
 - PAVED STATE OR U.S. HIGHWAY
 - STATE HIGHWAY
 - PAVED LOCAL ROAD
 - GRAVEL LOCAL ROAD
 - GRADED & DRAINED LOCAL ROAD
 - UNIMPROVED LOCAL ROAD
 - HIGHWAY BRIDGE ON FEET OR MORE IN LENGTH
 - PAVED FORD OR LOW WATER BRIDGE
 - MILEAGE BETWEEN POINTS
 - LAKE, RESERVOIR OR POND
 - LAKE, RESERVOIR OR POND WITH DAM
 - WIDE RIVER OR STREAM
 - DOCK, PIER OR LANDING
 - INTERMITTENT NAVIGATION
 - DAM WITH LOCK
 - SMALL STREAM
 - CORPORATE LIMITS AND ROADS THROUGH TOWN
 - COUNTY SEAT
 - OTHER CITIES AND TOWNS
 - MUNICIPAL AIRPORT
 - PRIVATE AIRFIELD
 - FARM UNIT OR DWELLING
 - GROUP OF CLOSELY SPACED DWELLINGS (1/4" TO 1/2" FROM SHOW)
 - CHURCH OR OTHER RELIGIOUS INSTITUTION
 - SCHOOL
 - POST OFFICE + POST OFFICE AND BUSINESS
 - CEMETERY
 - CHURCH WITH CEMETERY ADJACENT
 - BUSINESS ESTABLISHMENT
 - FACTORY OR INDUSTRIAL PLANT
 - GRAVEL PIT QUARRY
 - TOWN OR COMMUNITY HALL
 - FIRE ENGINE HOUSE
 - TRAILER PARK
 - OBSERVATION OR LOOKOUT TOWER
 - CAMP OR LODGE
 - SMALL PARK (ON STATE OR COUNTY MAPS ONLY, NOT PRIVATE BEST AVAILABLE)
 - WATER SUPPLY STANDPIPE OR TANK
 - SEWAGE DISPOSAL PLANT
 - CHICKEN HOUSE OR OTHER LIVESTOCK
 - SCENIC SITE OR OVERLOOK
 - PICNIC GROUND

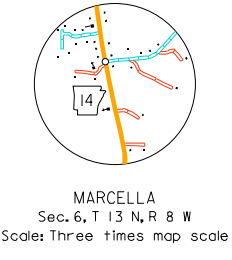

GENERAL HIGHWAY MAP
STONE COUNTY
ARKANSAS

PREPARED BY
ARKANSAS STATE HIGHWAY AND TRANSPORTATION DEPARTMENT
PLANNING AND RESEARCH DIVISION
IN COOPERATION WITH
U.S. DEPARTMENT OF TRANSPORTATION
FEDERAL HIGHWAY ADMINISTRATION
SCALE 1:62,500
MILES
KILOMETERS

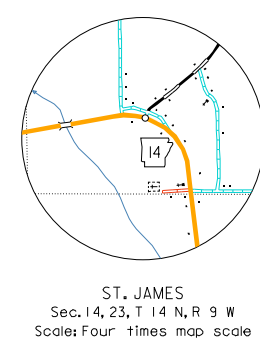
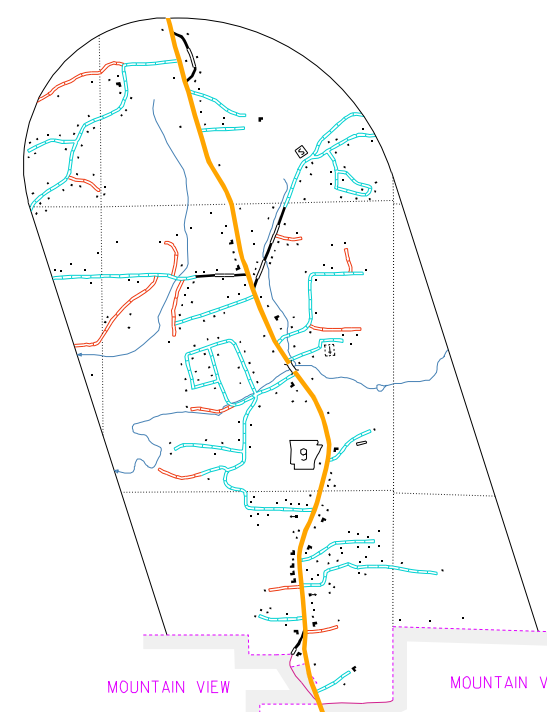
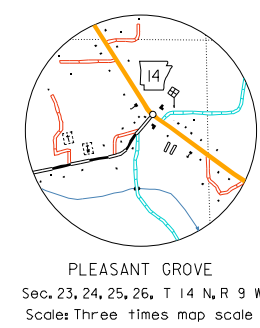
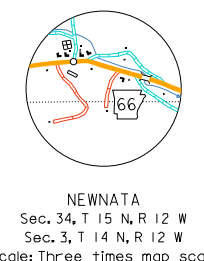
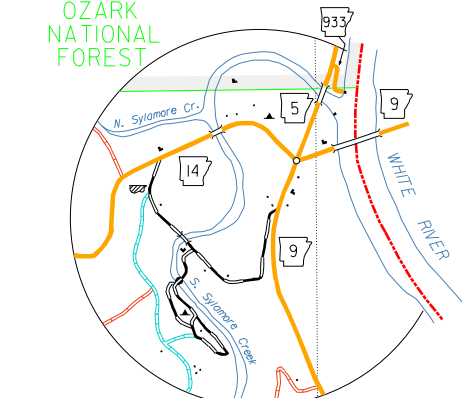
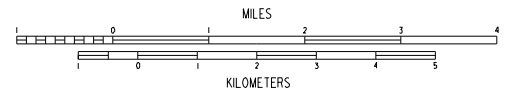

NOTE: Enlargements of all congested areas are five times map scale unless otherwise noted.
Individual maps are available for all active incorporated cities.
Area: 609.43 Square Miles
Population: 14,700 (2000 Census)
Map Issued: 10-31-04 - replaces map issued 12-0-95
File Inventory: 916
Map revisions made from aerial photographs taken 02-08-04
Map compilation completed 08-04-04
County map produced using Computer Assisted Cartography.

Copies of this map are available at a nominal fee from the Arkansas State Highway and Transportation Department, P.O. Box 226, Little Rock, Ark. 72203

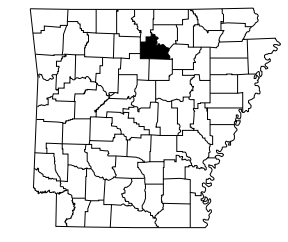

Projection: North American Datum